

MONTY MLINEK ESTATE AUCTION

SELLING: 160 ACRES +/- of TREGO COUNTY, KS

CROPLAND AND FARM EQUIPMENT

Tuesday, August 1st, 2018 at 10:00 a.m.
Auction Location: WaKeeney VFW Hall at 400 N. Railroad Ave, WaKeeney, KS
Come Early for Refreshments and to Register

LEGAL DESCRIPTION: The Northwest Quarter (NW/4) of Section Fourteen (14), Township Twelve (12) South, Range Twenty-five (25) West of the 6th P.M., Trego County, Kansas being 160 acres more or less.
Land & Equipment Location: From Collyer, Ks. go 2 ½ Mi. East to 150 Ave and 2 Mi. South to CO RD I will be the Northwest corner of the property. From the Voda exit on I-70 go 1/2 mile South on 180th Ave to CO RD I and go 3 miles west to the Northwest corner of the property.
Farm Equipment is located ½ Mi. South at the Farmstead

NOTE: The Farm Equipment Will be Sold by Video at the VFW Hall Immediately Following the Land Auction

WATCH FOR SIGNS

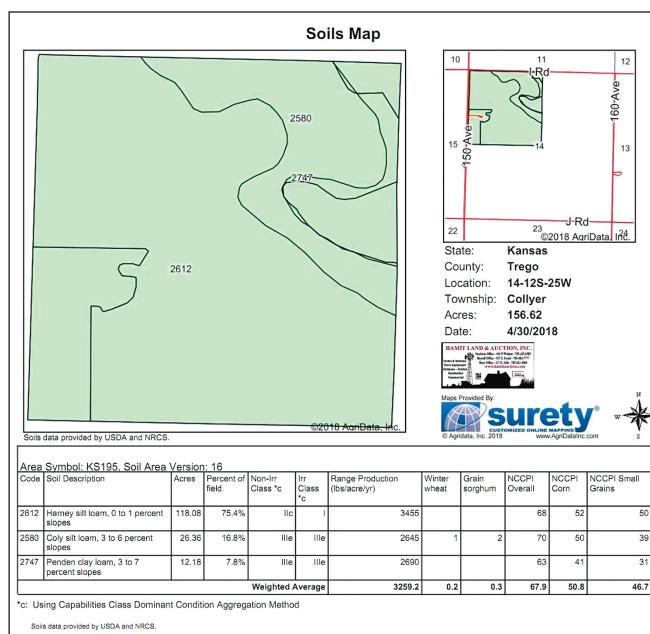

GENERAL INFORMATION: This tract of land has 140 of cropland with the balance being farmstead and grass. The property is not currently enrolled in any government program.

TERMS, POSSESSION & TAXES: Option 1-10% down day of sale, balance due upon Title approval and delivery of good and sufficient deed with possession immediate upon closing. Option 2-20% down day of sale, balance due upon Title approval and delivery of good and sufficient deed with possession immediate day of sale. Sellers shall pay all the 2017 taxes and prior years' 2018 taxes to be prorated to date of closing based on the 2017 rate. 2017 Taxes were \$1,491.54

MINERALS: Sellers shall convey 100% of the seller's minerals to the purchaser. All minerals are believed to be intact.

TITLE INSURANCE AND CLOSING: Owner's policy and closing expense will be shared 50/50 between the buyer and sellers. Mortgage policy, if required, will be the expense of the buyer. Closing shall be on or before August 24th, 2018.

CONDITIONS: Buyers are encouraged to verify details and view property prior to the auction. Announcements made day of sale shall take precedence over printed material. This auction sale is not contingent upon the purchaser's ability to finance the purchase. Buyers must make finance arrangements, if needed, prior to the auction.



VEHICLES & EQUIPMENT - 1979 Ford Model TW 20, 2 Remotes, No 3pt, Showing 1211 Hrs, SN C610616 - 1952 Farmall Model M Tractor W/Farmhand F11 Loader, Dirt & Manure Buckets & Hay Basket SN FKB 294650X - Flex King 3 X 5 Undercutter W/Richardson Treaders, NH3 Setup - Quinstar Follow Master II Field Cultivator W/Harrows, 27in. Sweeps, Harrows, SN-FM94031750 - 1976 Chev. Scottsdale ¼ T., 454 V8 on Propane, 2X4, Needs Work - Gravity Box W/Running Gear, Approx. 150 Bu. - Land Pride 15-72 3pt Rotary Mower - 3pt 6ft Back Blade - 3 Section JD LZ Hoe Drills, 8 X 12 - 6in X 36 PTO Grain Auger - Pickup Fuel Tank W/Hand Pump - 300 Gal Fuel Tank W/Stand - JD Dump Rake

NOTE: The Farm Equipment Will be Sold by Video at the VFW Hall Immediately Following the Land Auction



SELLER: Monty M. Mlinek Estate, Larry R. Mlinek-Administrator
Stan Basgall, Attorney for the Monty M. Mlinek Estate

Terms & Conditions for Equipment: Cash - Approved Check W/Positive ID - Credit Cards Accepted: Visa & Master Card - There will be a 3% Administrative Charge on All Credit/Debit Card Purchases - All Items Will be Sold "As-Is Where-Is" - Not Responsible for Accidents - Announcements Made Day of Sale Take Precedence Over Printed Material

HAMIT LAND & AUCTION, INC.

Stockton Office - 104 N Walnut - 785-425-6585
Russell Office - 927 S. Fossil - 785-483-7777
Hays Office - 117 E. 13th - 785-621-3000
www.hamitauction.com

Farms & Ranches
Farm Equipment
Antiques - Estates
Residential
Commercial

NAA
AUCTIONEER

Kansas
AUCTIONEER